

Biodiversity Area - Ariel Sharon Park

Masterplan Latz + Partner

Braudo Maoz Landscape Architects Ltd

Additional design to be integrated into the Landscape Masterplan by Latz + Partner



Existing situation: Northern fringe of the new Ariel Sharon Park



Planning concept: Restoration and creation of wet habitats



Planning concept



A recreational area and an urban nature center will be built on an area of about 50 acres north of the renovated hill, as part of the main entrance to the park.

The visitors will experience a gradual transition from the busy urban area through a leisure and recreation area to the first Urban Nature Center in the Tel Aviv area, which will serve as a model for the development of natural infrastructure in the Dan region. From there, the public will be able to travel on foot or by bike to the surrounding Hiriya hill, and to the natural areas surrounding the Eilu river.

Targeted user groups



The compound will include two clusters of major activities - urban nature and leisure and recreation activities. The planning will provide a solution for a sustainable integration between the extensive and the expected intense activity.

In this context, the planning of leisure and recreation activities will be in accordance with ecological principles in order to prevent environmental disturbance to the biodiversity that will develop in the area. Urban nature activities will include guided groups (school and others) and independent nature enthusiasts.

Plan of the northern entrance area of Ariel Sharon Park

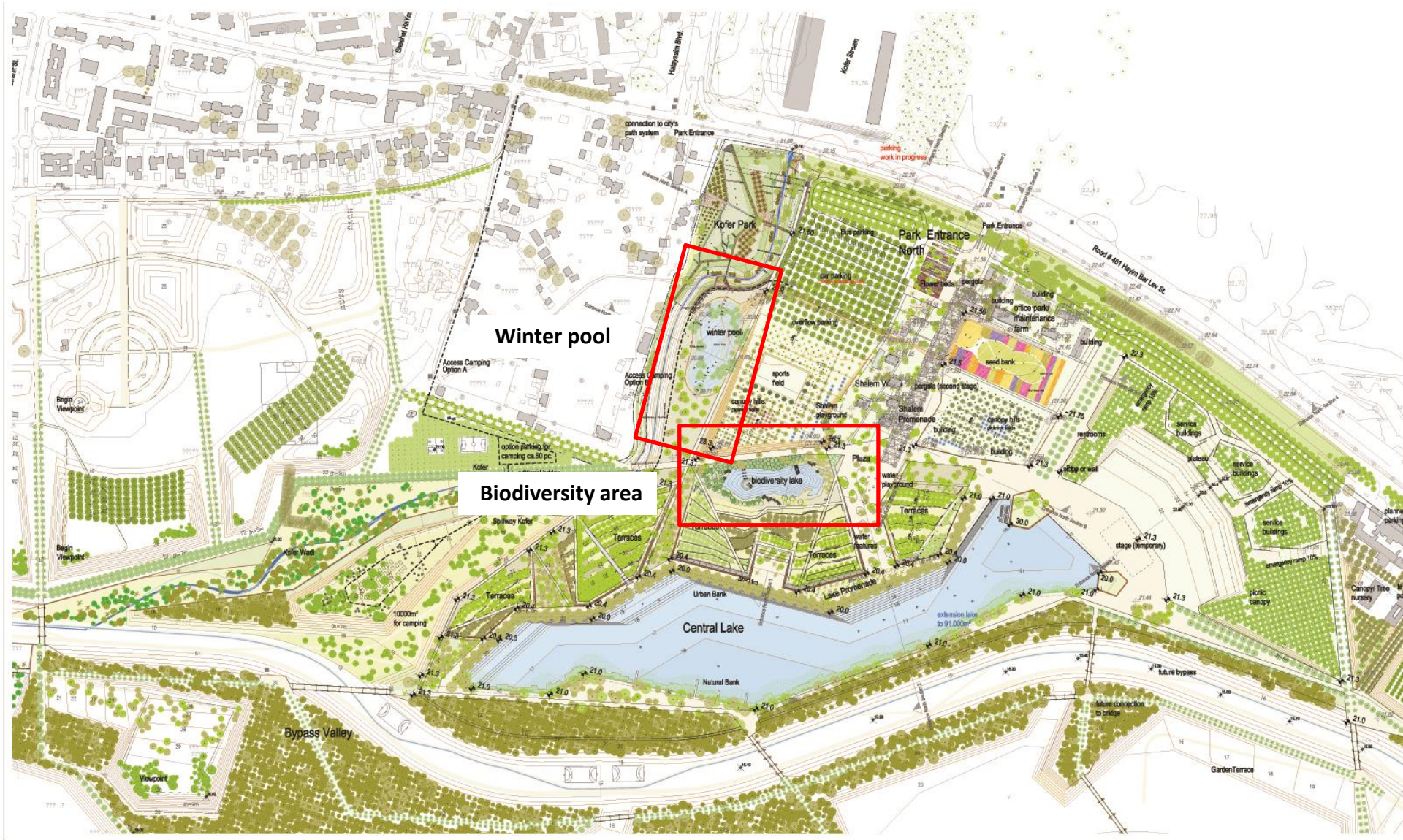

Traffic and accessibility in the northern entrance area

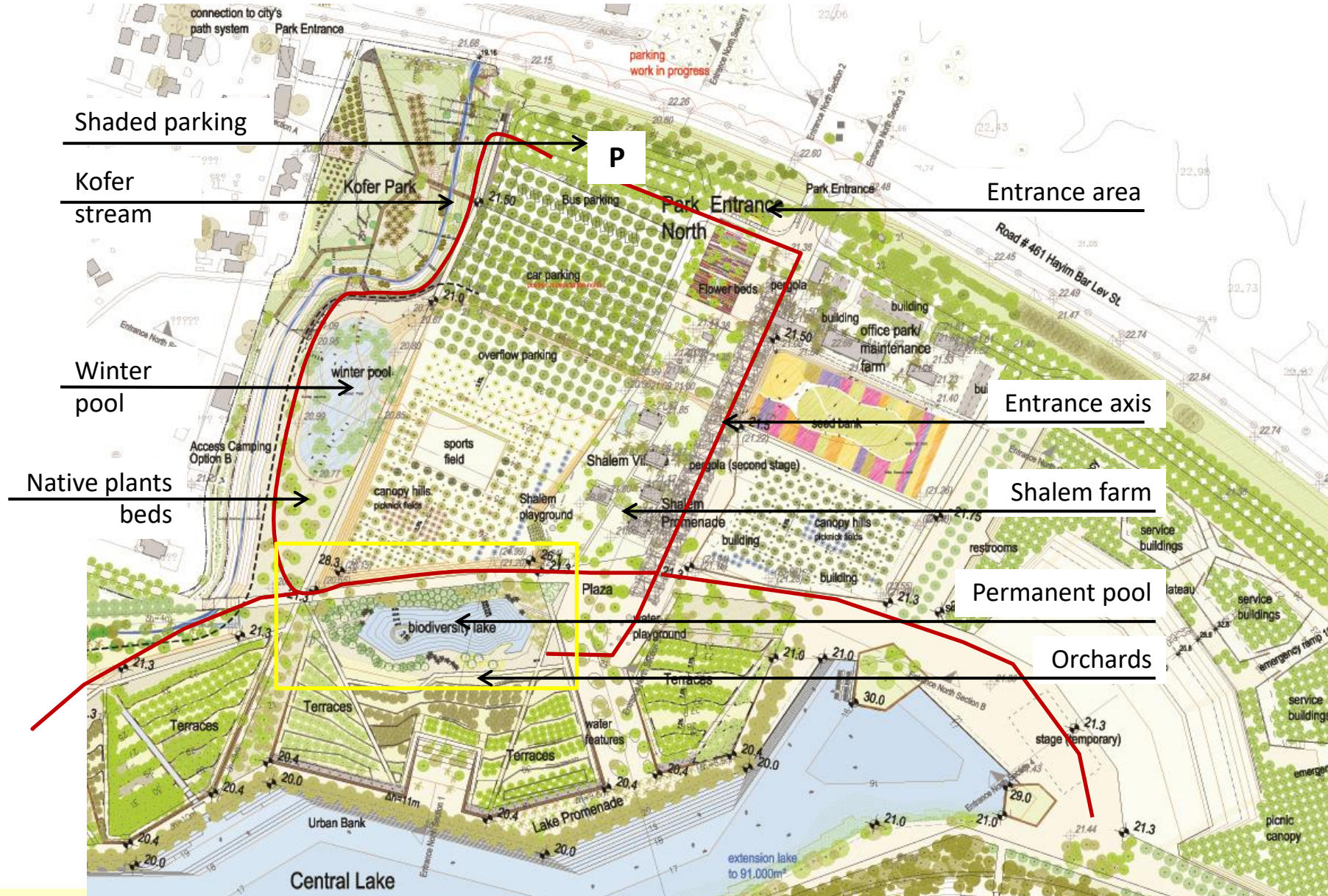

General design program for the northern entrance area

Ecological design guidelines propose the restoration of the original landscape of the region and the restoration of local species such as Jujube, Tabor oak, and orchards.

The planning goal is:

- to develop an area that forms part of a larger continuum of open spaces, allowing the transition of plants and animals from one area to another;
- to create a topographical range and multiple areas in the pond for the purpose of encouraging different habitats;
- to separate between areas of human activity and areas of habitats and animals.



Important landscape elements:

1. Permanent pool - A water body of about 4 acres is implemented according to the instructions of a bird expert and ecologist
2. Orchard – The terraces surrounding the lake for bird watching are planted with a variety of local trees (e.g. olive, oak, carob, almond)
3. Seasonal winter pool in the size of 4 acres
4. An area of typically native Israeli vegetation

The planning area under construction



Cross section
Winter pond

Biodiversity area

Kofer canal
נחל כופר

Trail
שביל טיול

Vegetation buffer
חיץ צמחי

Winter pond
בריכת חורף

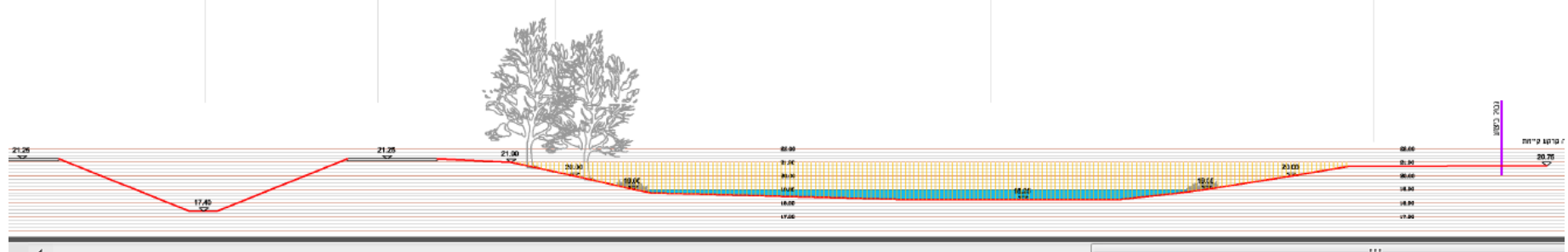

זברות לקרקע קיימת



משרד ברידא מעוז- אדריכלות נוף בע"מ

מגוון ביולוגי- פארק אריאל שרון

Winter pool: Construction stages

- Stage a 
- Stage b 



Winter pool

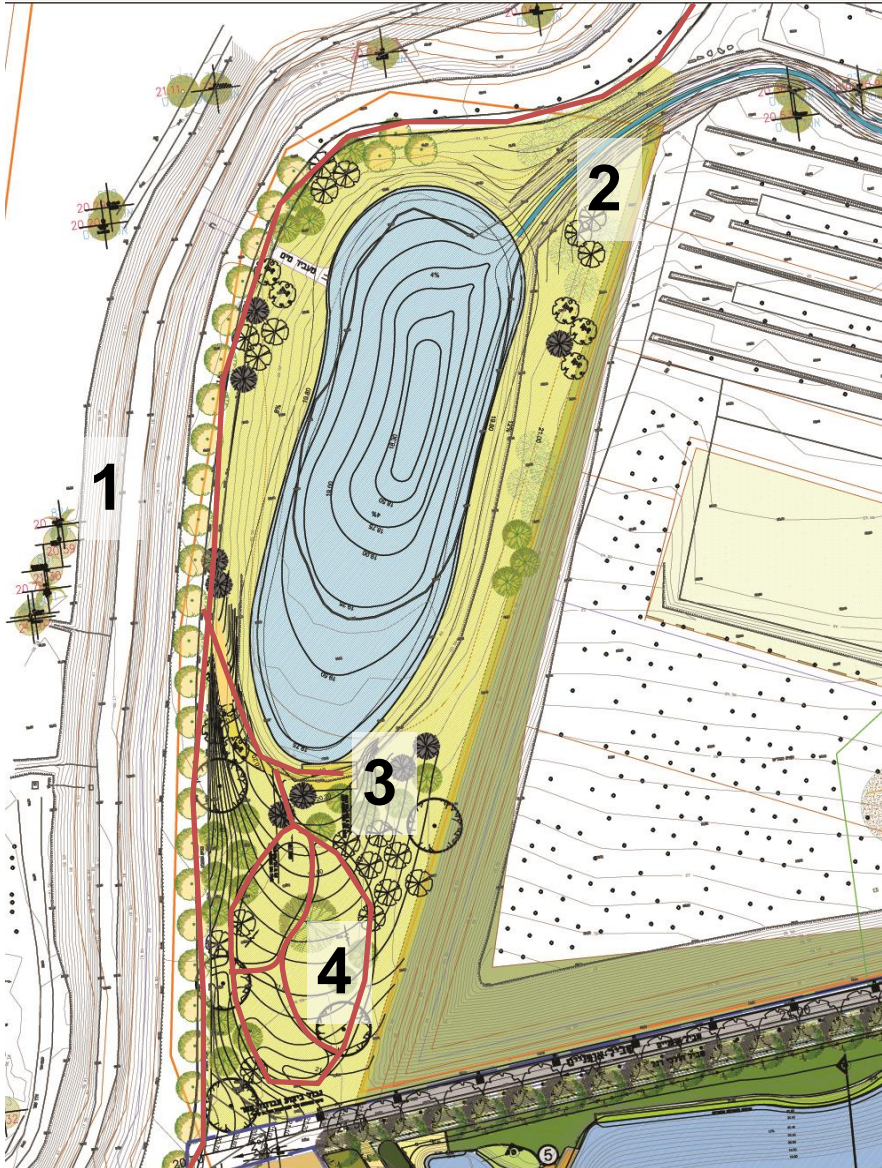

1. Kofer stream promenade
2. The drainage canal for runoff water leading to the winter pool
3. View points and bird hide positions allow to view the water body without disturbance
4. Wildflower bed



Winter pool



Biodiversity area: Construction stages

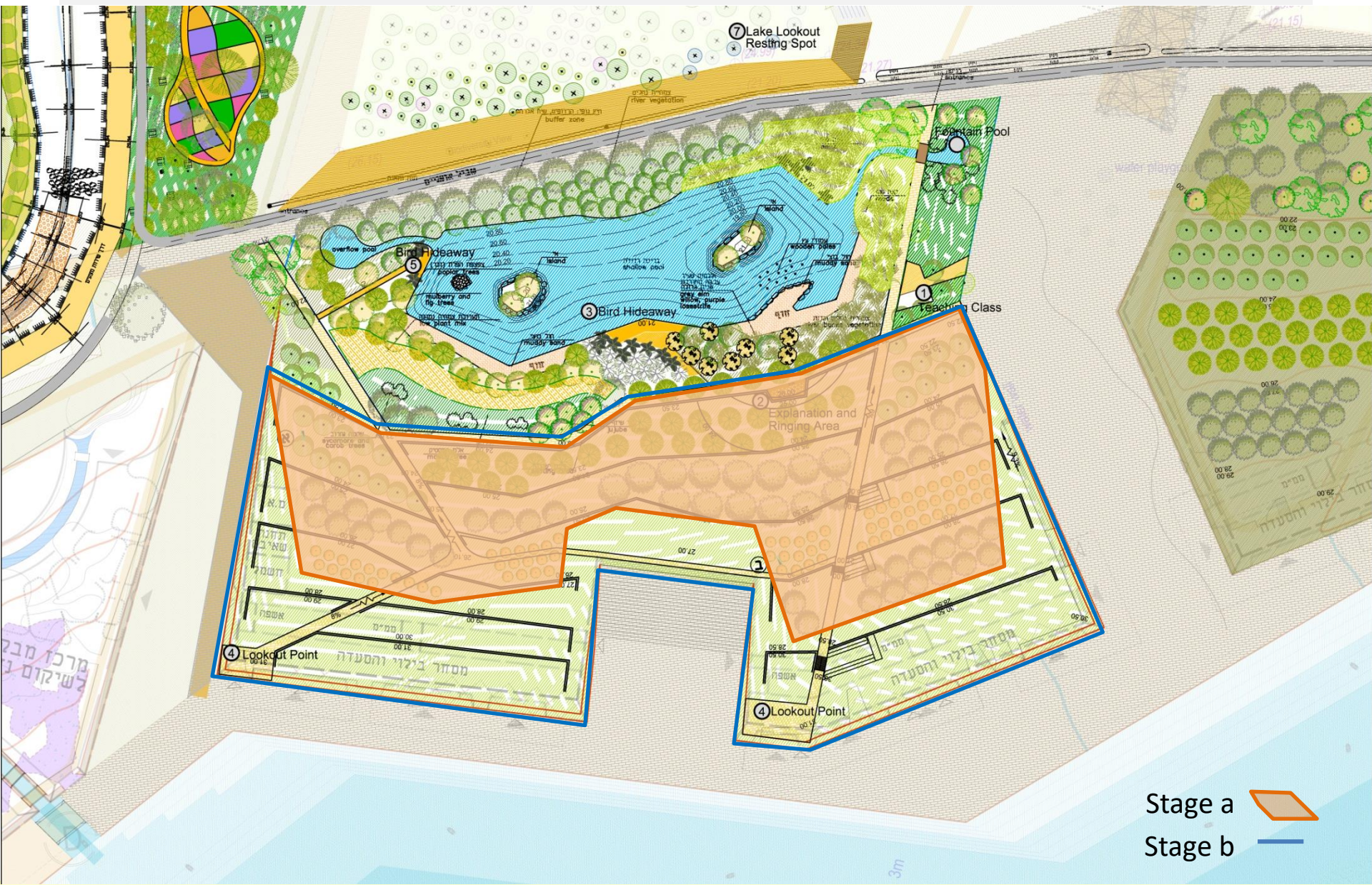

Biodiversity area: Trail network



Biodiversity area: Important elements and definition of habitats

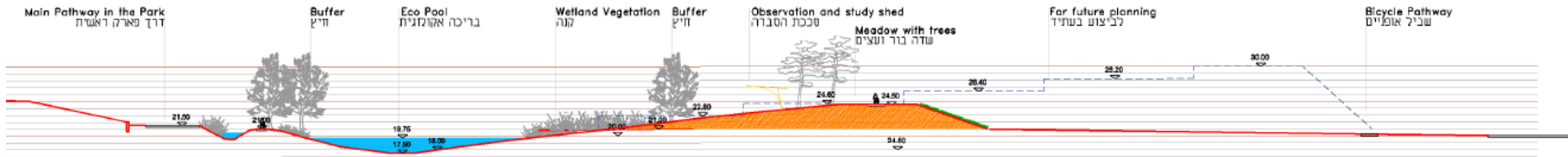

1. An meeting area that allows for a gathering, introductory training and an outdoor class.
2. Bird Ringing Station - Demonstration for the general public and use of researchers
3. Bird hideaway stations allows viewing the birds in the water body without interference
4. Lookout points on the terraces that provide an overview of the entire area
5. Creating a vegetation barrier between the intensive and extensive areas.

The differing slopes and vegetated areas of the biodiversity pool provides habitats for various water birds and other aquatic animals.

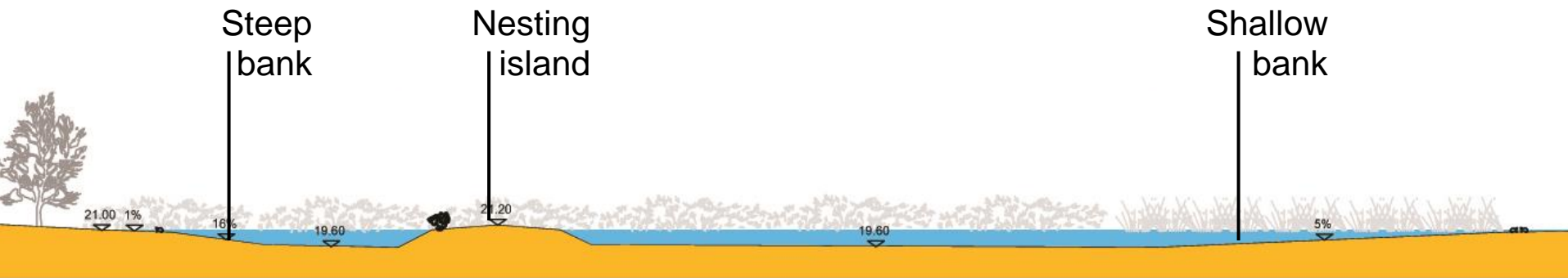

Biodiversity area: Design elements

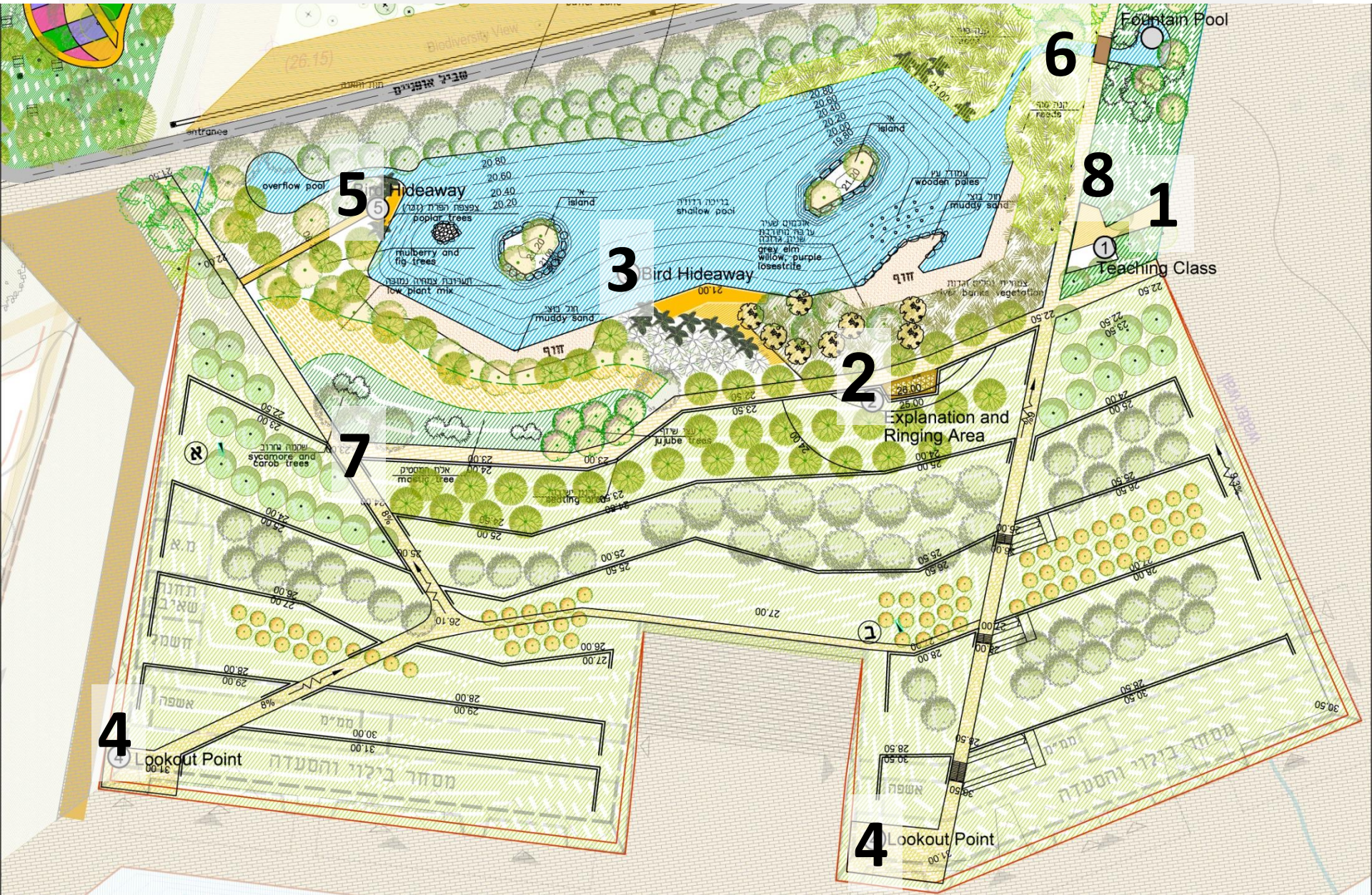



1 GATHERING AREA AND OUTDOOR CLASSROOM

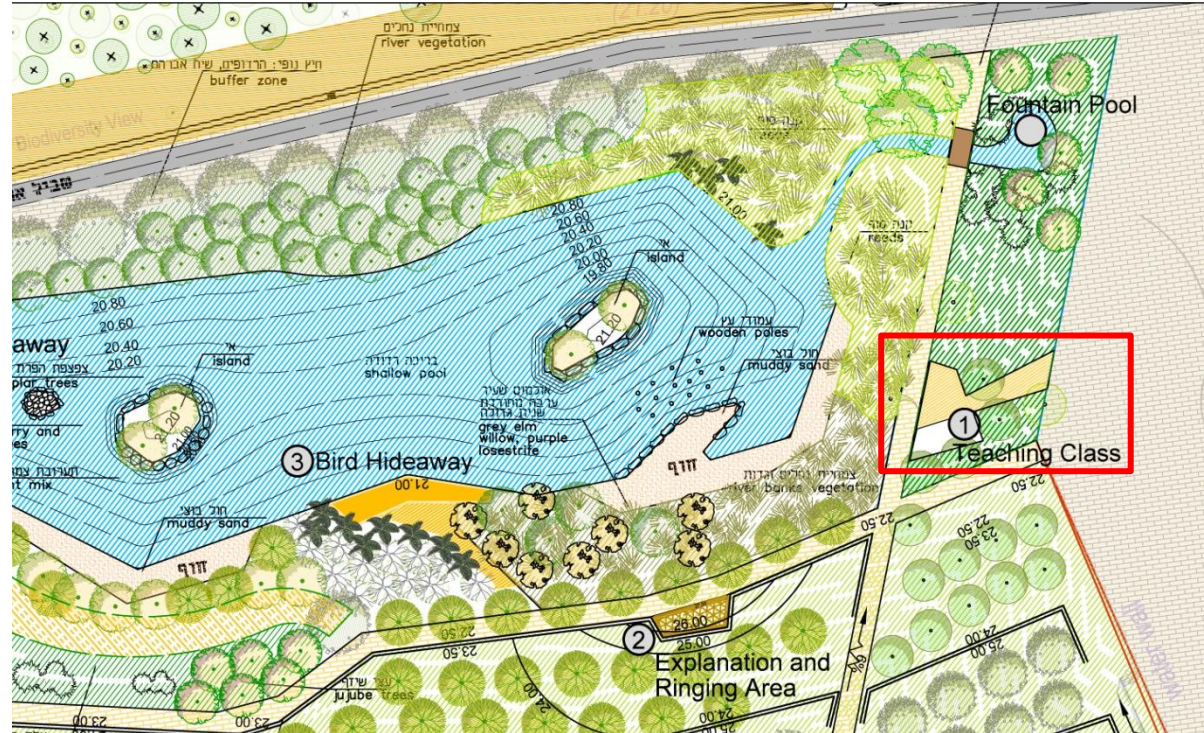

Outdoor classroom



Bamboo Deck



Bamboo Deck

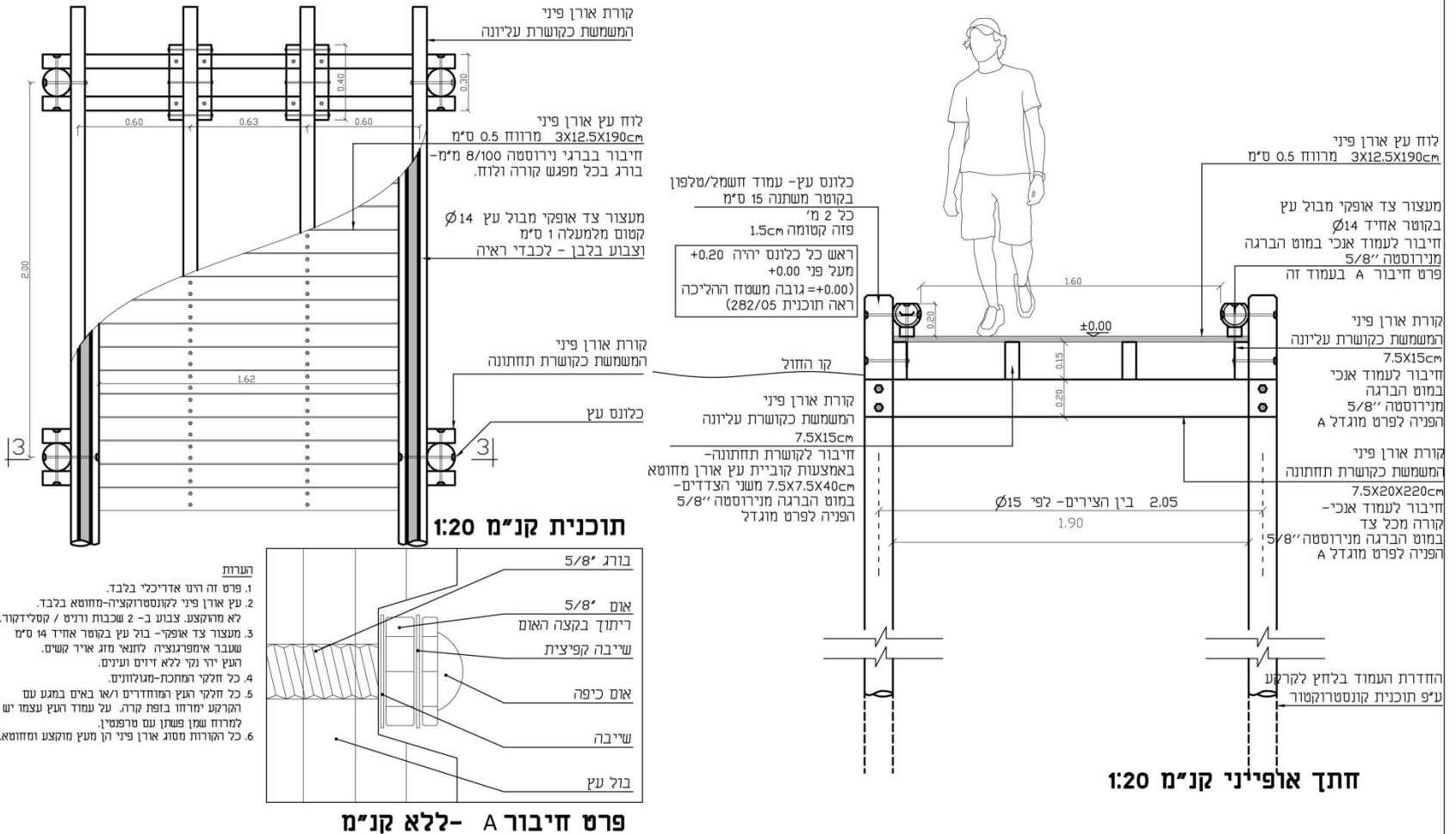

	שם הפרוייקט: פארק אריאל שרון - מתחם המגוון הביולוגי	תאריך: 17.04.14	שם הקובץ: P:\486\OFFICE\DETAILS\D486-03B.DWG	מהדורה:	תאריך עידכון:	שם המעצב: בראודו • מאוז אדריכלות נוף בע"מ BRAUDO • MAOZ LANDSCAPE ARCHITECTURE LTD רח' יוסף קארו 18, ת"א 6701422 נוב. 03-7528197 ב.ק.ס. 03-7515827
	תוכן הגיליון: שביל דק מרחף	אין לבקוע מידות טיי מדידה בשרטוט. המבצע אחראי לכדייקת המידות והתאמתן במקום ועליו להודיש למתכנת על כל טעות או אי התאמה.				

Bamboo Deck

the bamboo x-treme benefits



hard & durable

Class 1 in accordance with EN1307 and EN113/EN350. Exceptionally hard: Brinell >9,5kg/mm².



high stability

More stable than bangkirai (yellow balau) and other tropical hardwoods.



easy to install

Various installation possibilities: fastener installation or screw down; use of either flat or ribbed side.



economical

Simple and fast installation: Up to 30% savings in costs! Reduced loss of material because of the head side tongue and groove.



beautiful appearance

A beautiful, natural hardwood look. Choice for natural greying or keeping brown colour with maintenance.



endless resource

Made from MOSO bamboo, the fastest growing plant on earth. Consisting of approx. 90% natural bamboo fibres.



CO₂ neutral

Official LCA and carbon footprint studies (ISO 14040/44) confirm that Bamboo X-treme is CO₂ neutral over the full life cycle.



warranted quality

Patented MOSO product, coming with a product guarantee of 10 years. Bfl-S1 fire safety classification (EN13501-1).

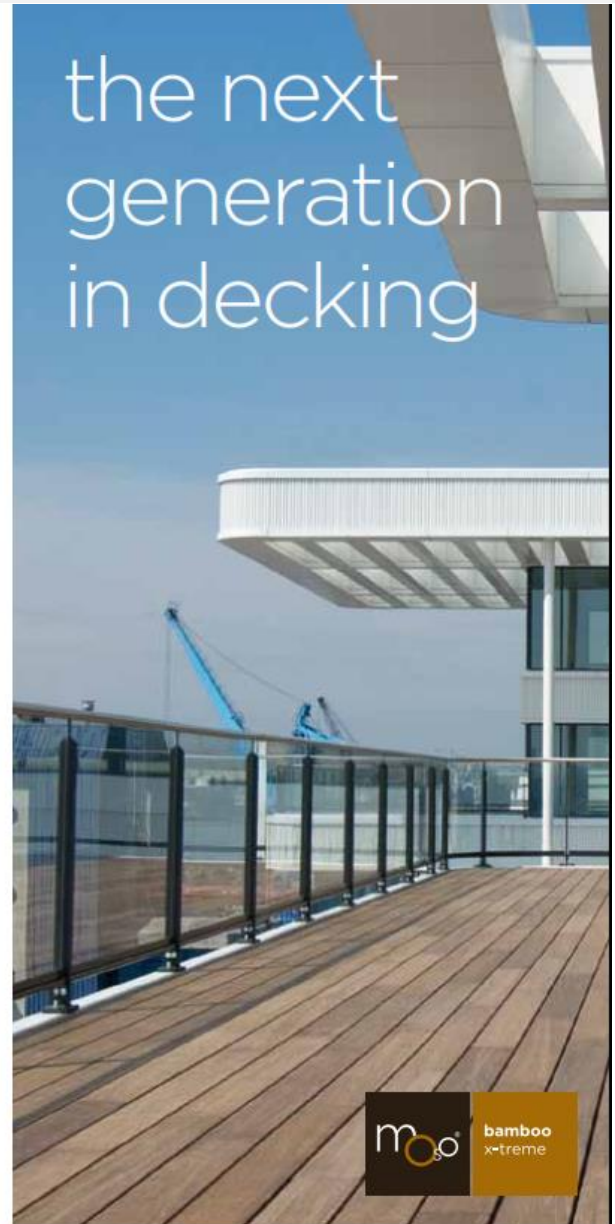

the next generation in decking

www.bamboo-xtreme.eu  **bamboo products**



Bamboo Deck



the fast growing hardwood alternative



up to 30% savings in installation costs

bamboox-treme

With the introduction of Bamboo X-treme, MOSO has developed a truly **ecological** and **durable** alternative for increasingly scarce tropical hardwood. MOSO uses a unique patented process to alter the **hardness, dimensional stability** and **durability** to a level **superior** to the best tropical hardwood species.

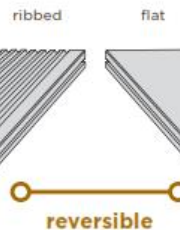

Product	Code	Dimensions (mm)
Board unfinished	BO-DTHT170G	1850x137x20
Board pre-oiled WOCA	BO-DTHT171G	1850x137x20
Board unfinished	BO-DTHT190G*	1850x155x20
Board pre-oiled WOCA	BO-DTHT191G*	1850x155x20
Sub frame joist	BO-SB150	2440x70x40
Fastener	CLIP-SCREW-BX03	27x22,5x10,8

*) Check availability.



after 12-18 months weathering after brushing & cleaning after application with water based oil

appearance and colour

Bamboo X-treme is a natural product, which can vary in colour, grain and appearance. The colour will change over time depending on the maintenance schedule. The boards have a brown to dark brown colour when installed, which turns into a lighter caramel colour several weeks after installation. Without further maintenance the colour turns grey as a result of UV radiation (similar to most other wood species).

maintenance and cleaning

The decking boards should be treated with a water based oil (e.g. WOCA Exterior oil) no later than 3 months after installation. Please follow the instructions of the oil supplier. The surface of decking weathers under influence of wind, rain, frost and sunshine (UV). As a result, the surface may turn grey, dirty and rough. Annual maintenance and cleaning should be performed using a cleaner, silicium carbid brush or disk, after which a new layer of water based decking oil should be applied (all maintenance products are available through MOSO).



Check out the installation and maintenance movie at www.moso.eu/youtube

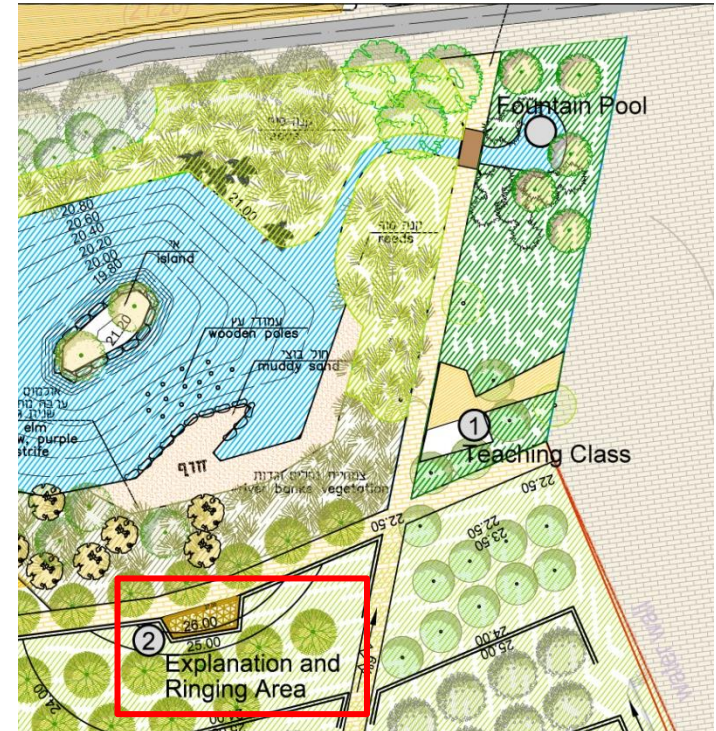

2 BIRD RINGING AND EXPLANATION ROOM

Bird ringing station with pergola: Floor plan

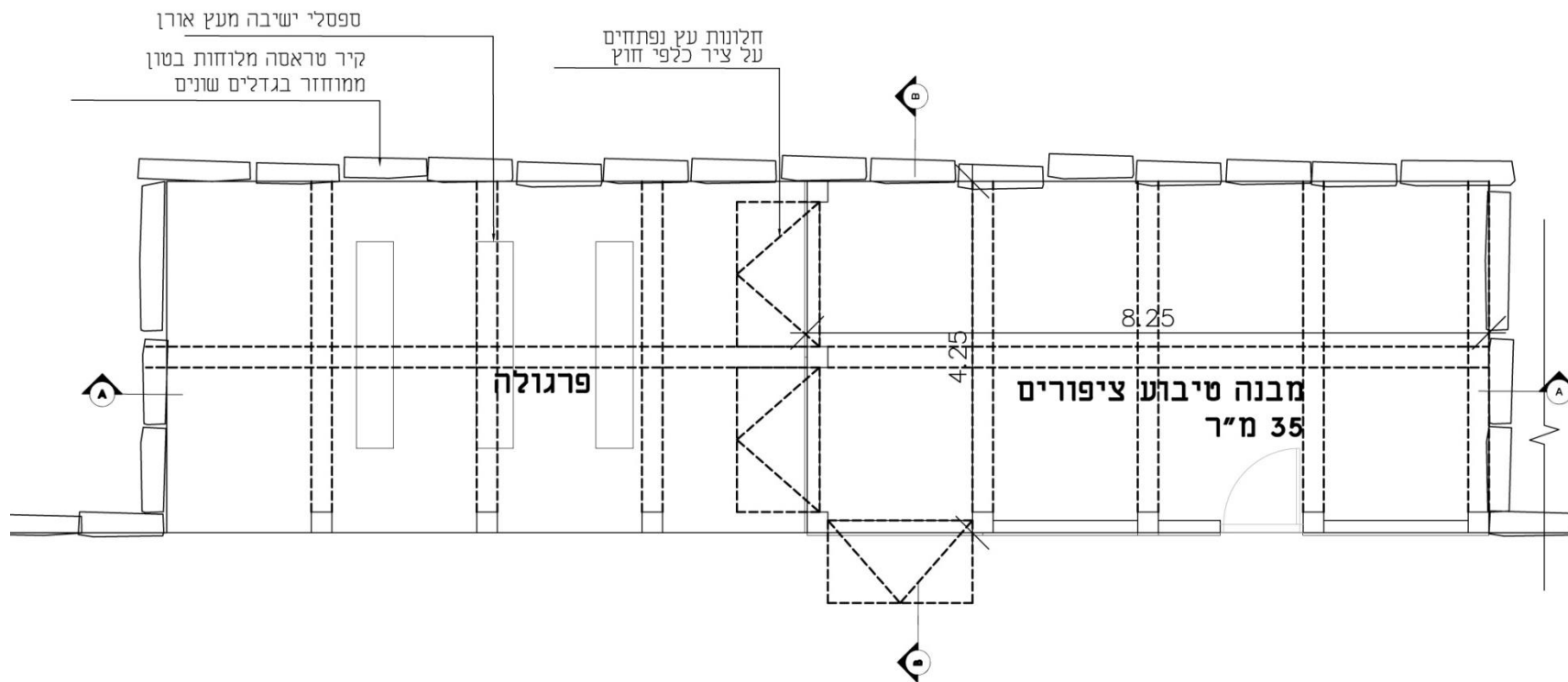

כיתת טיבוע ציפורים תכנית

Bird ringing station: Longitude section A-A

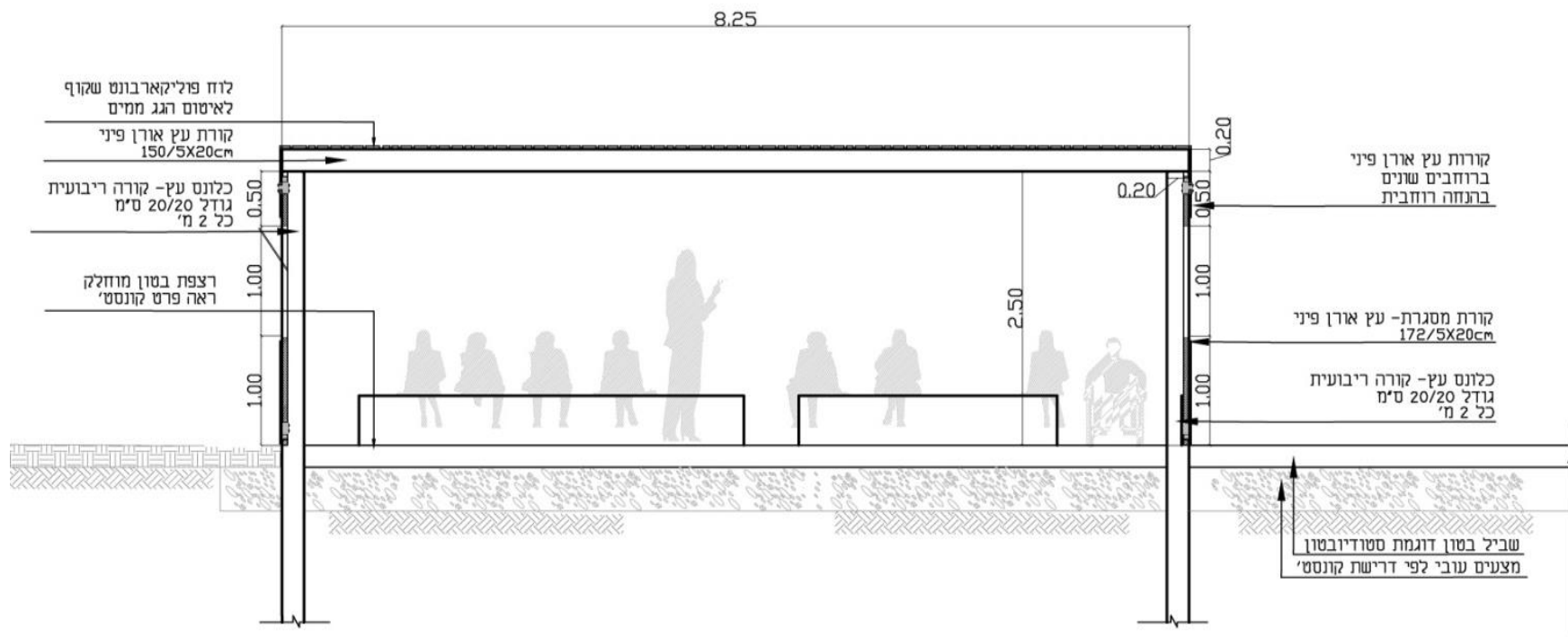

חתך A-A

Bird ringing station: Cross section B-B

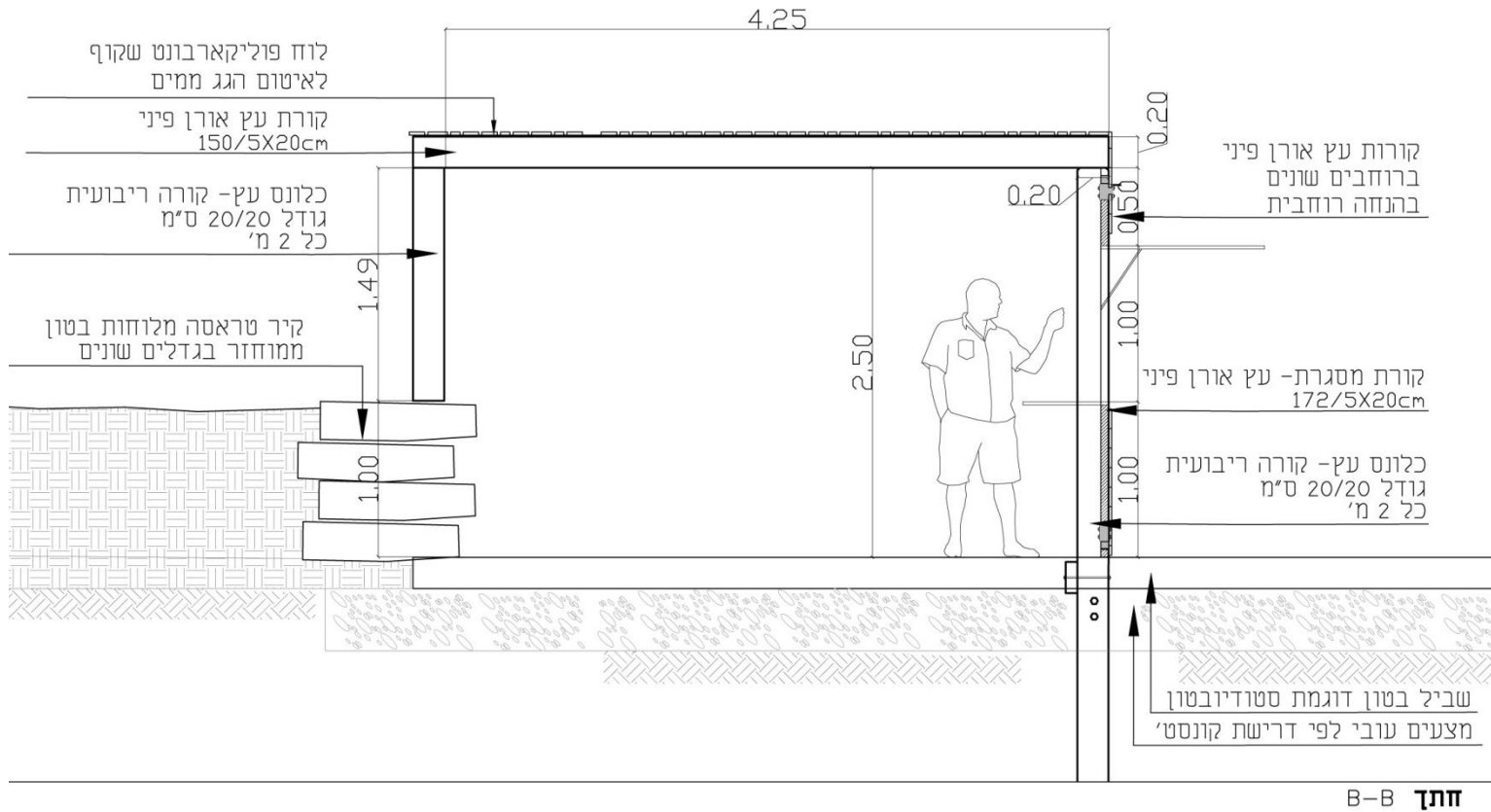

כיתה טיבוע ציפורים חתך

Bird ringing station



Constructed terraces: with planting / recycled concrete blocks



Constructed terraces: with planting / recycled concrete blocks



Terraces and Biodiversity area: Cross section

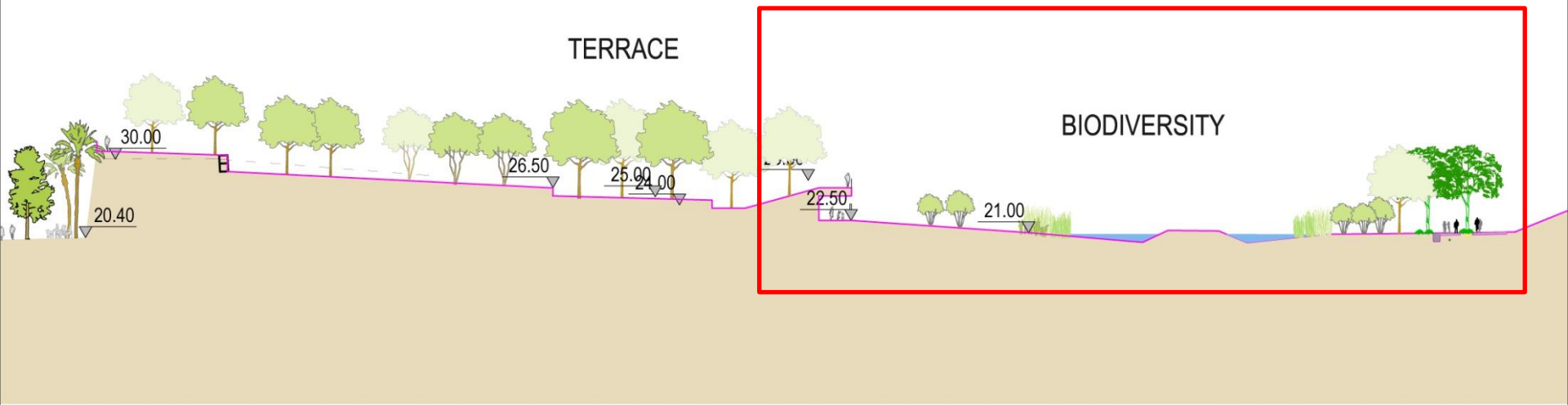

Biodiversity area: Cross section (zoom)

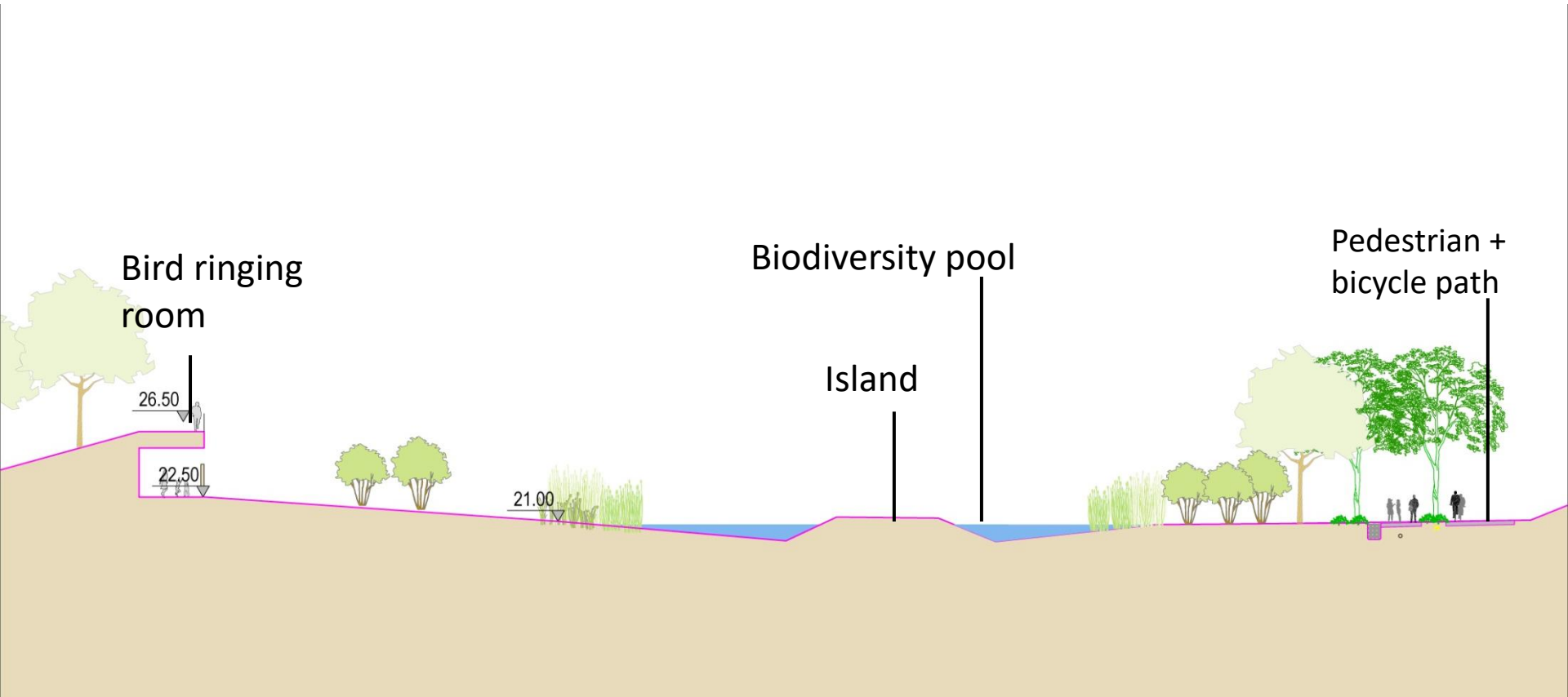



3 BIRD HIDEAWAY WITH ROOFED PATHWAY

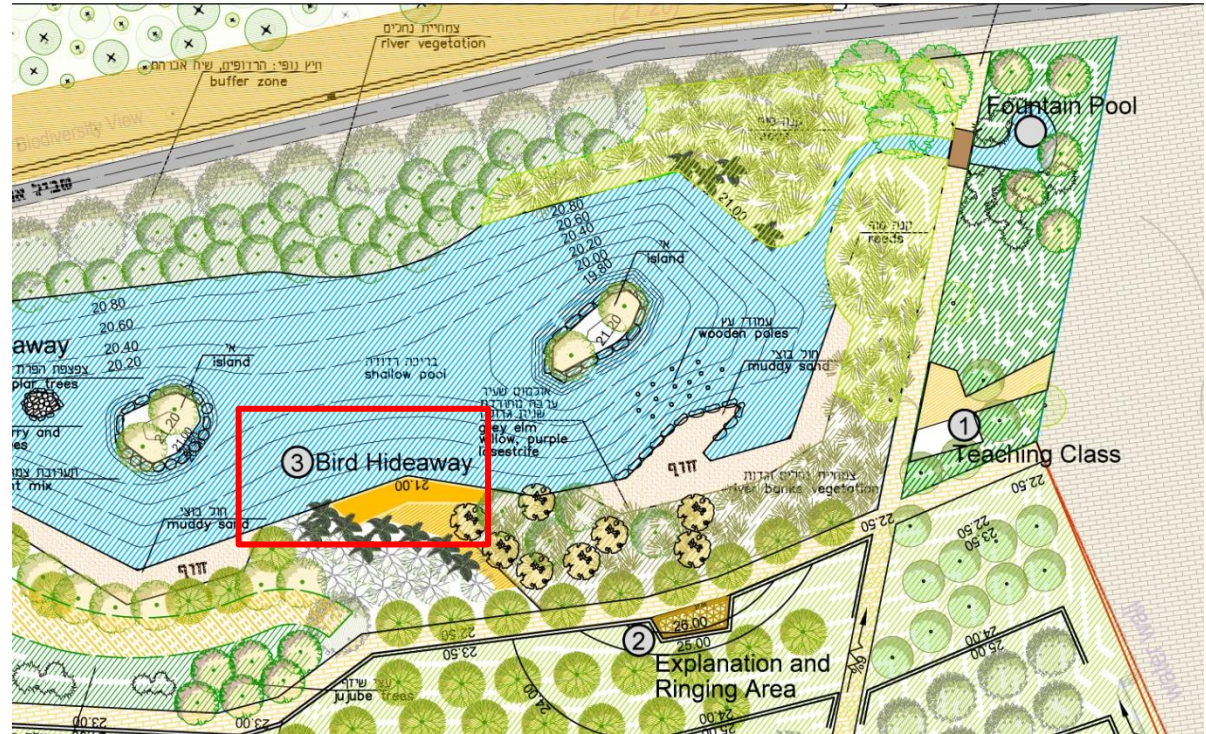

Bird hideaway with roofed pathway



Roofed pathway

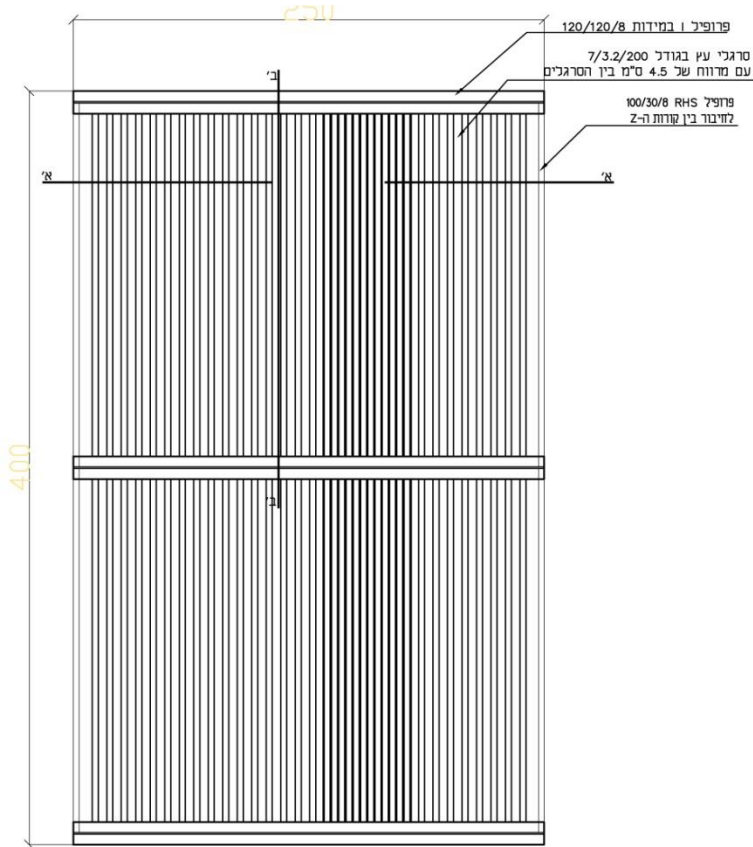

תכנית קנ"מ 1:50

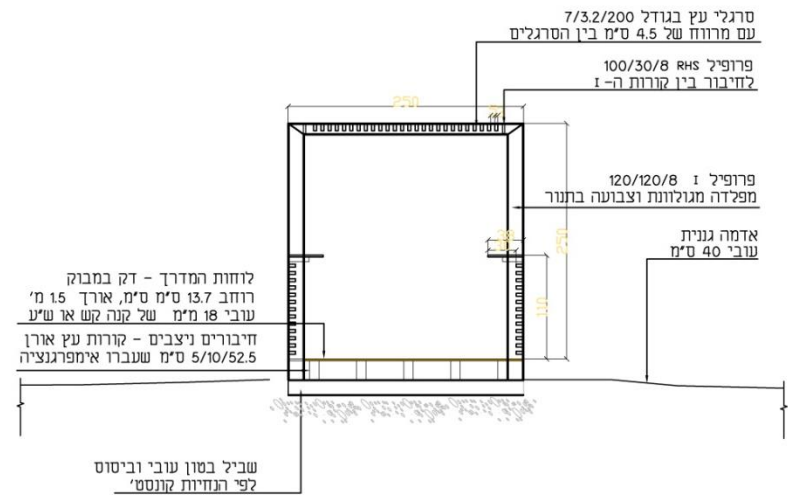
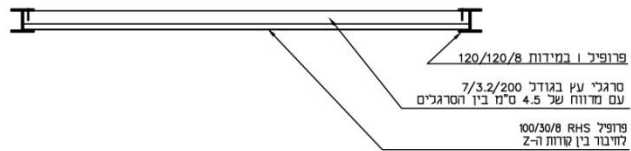

חתך א - א

חתך א-א קנ"מ 1:50

Roofed pathway

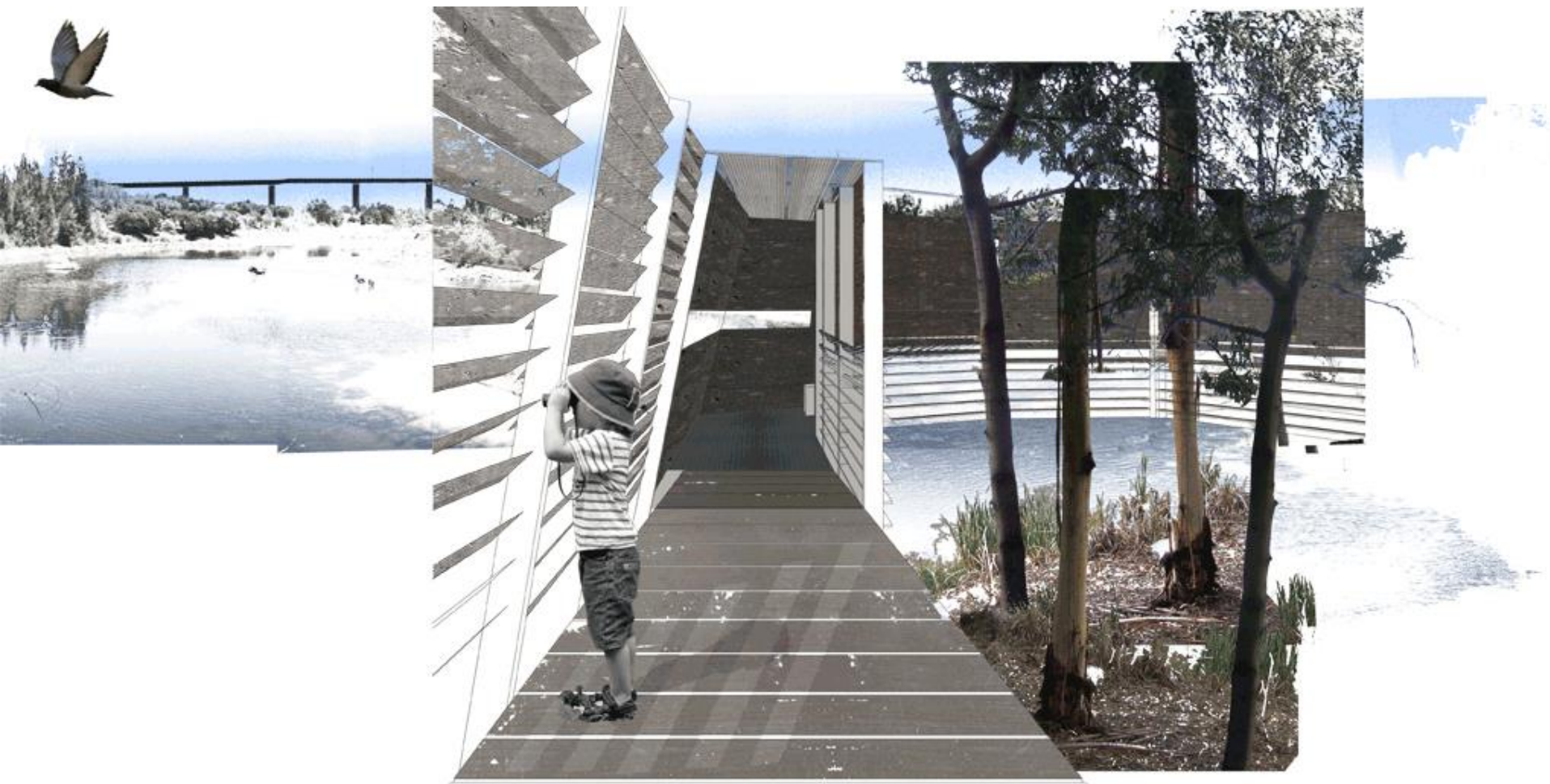

שבילים מקורים



4 LOOKOUT POINT

Lookout point

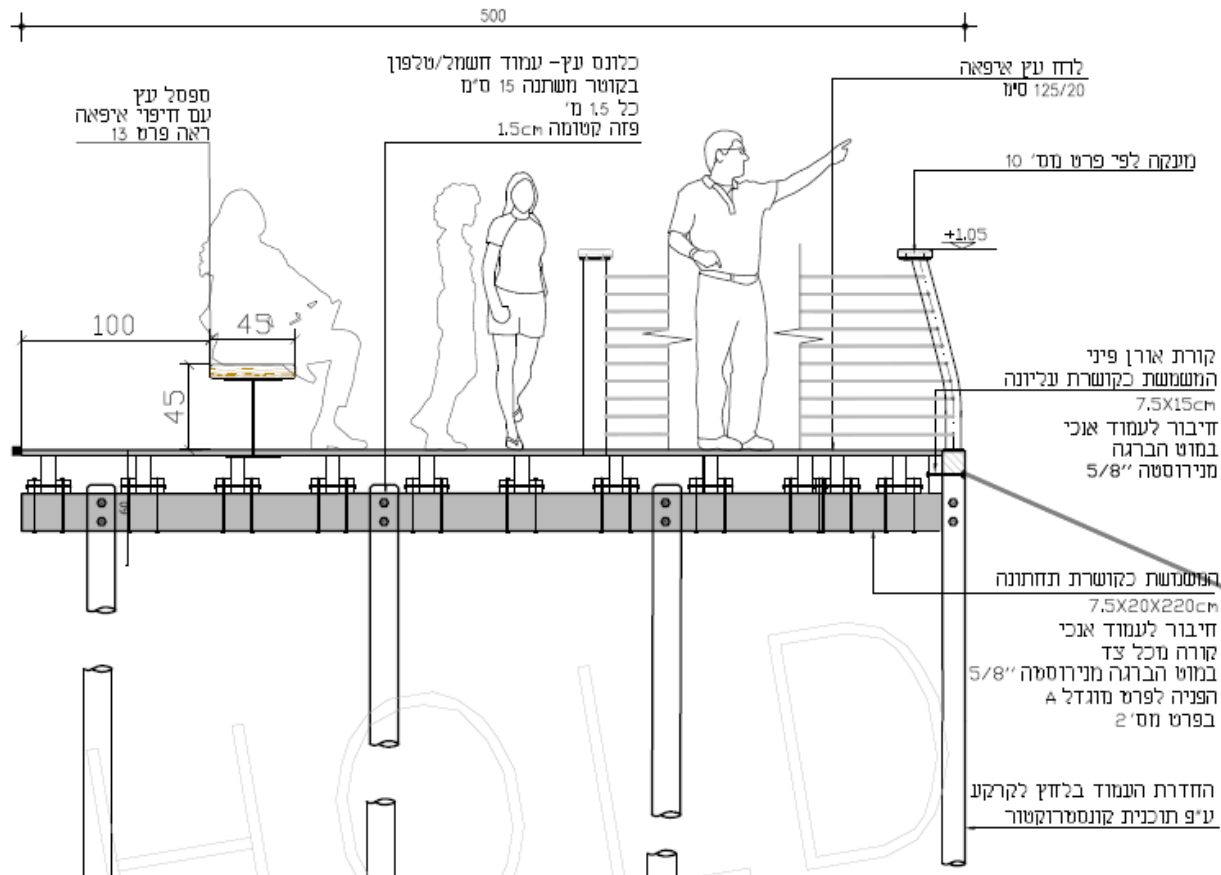

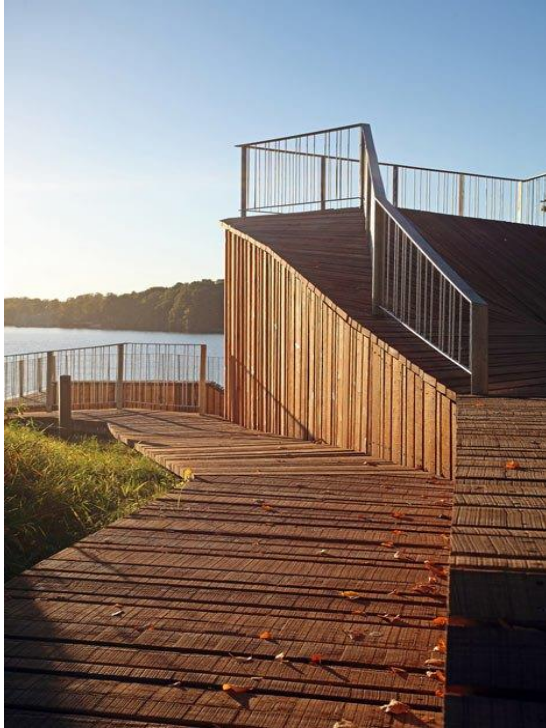

5 BIRD HIDEAWAY II

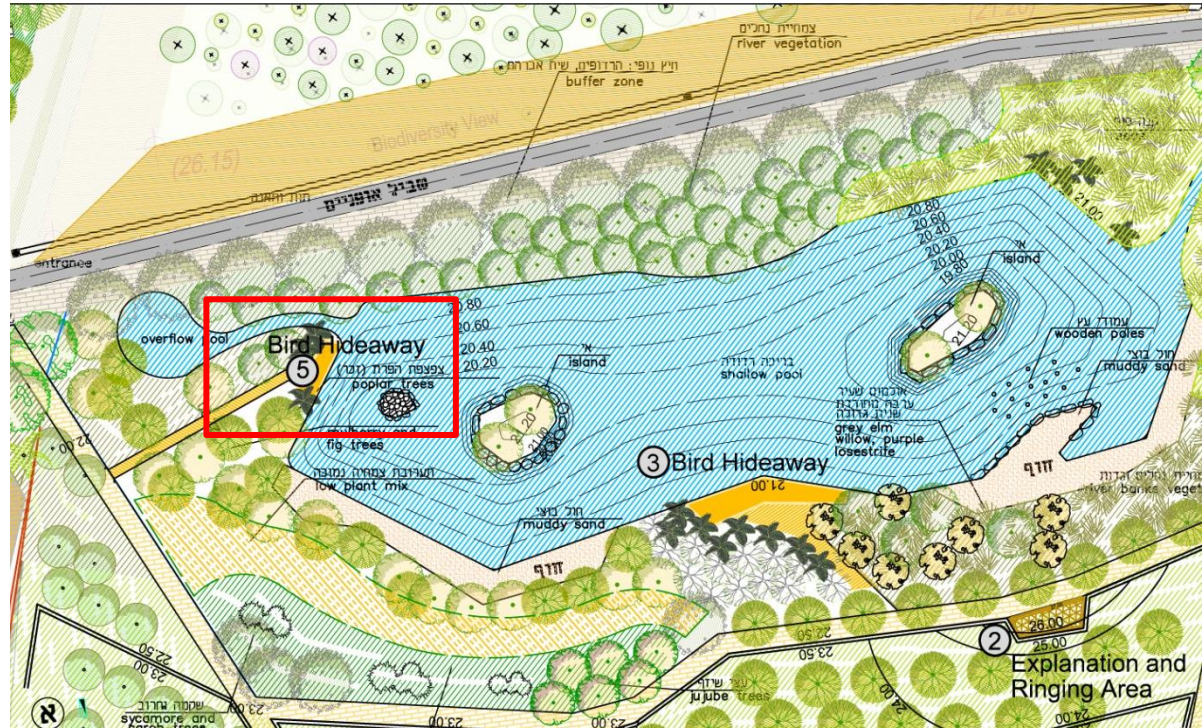

Bird hideaway II





6 FOUNTAIN POOL AND SMALL BRIDGE

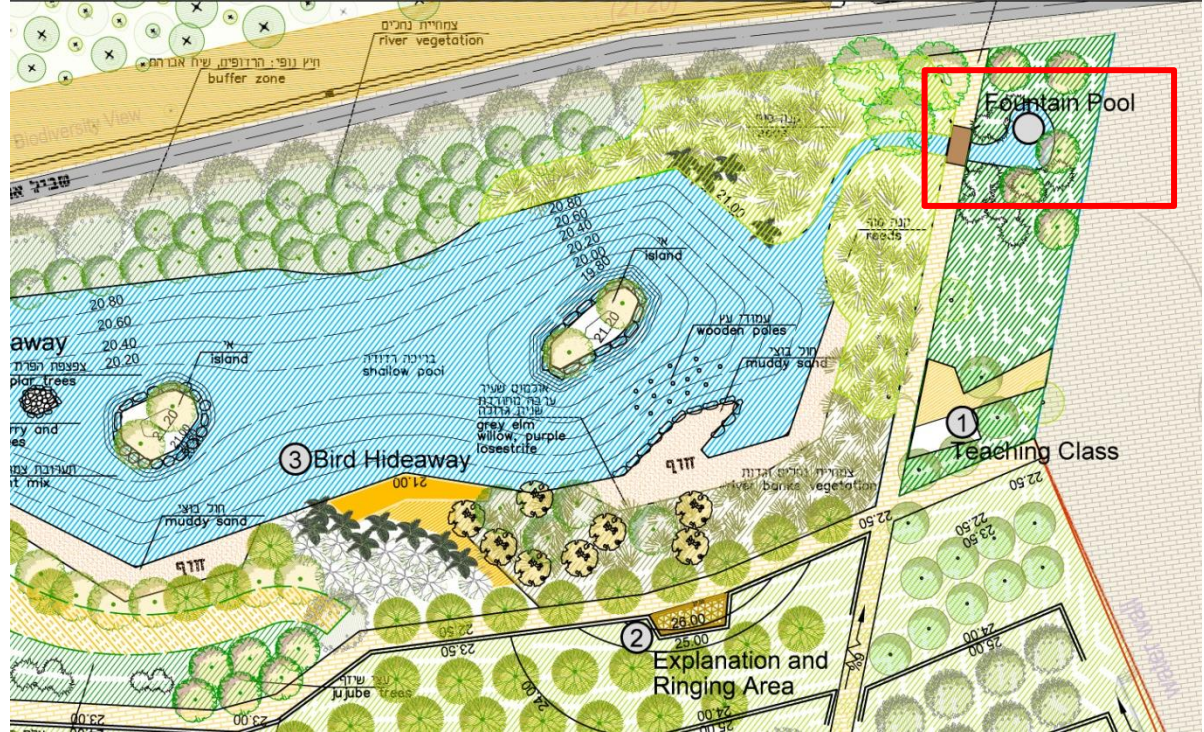

Small bridge

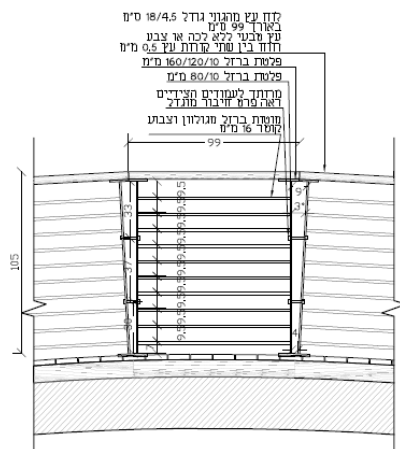
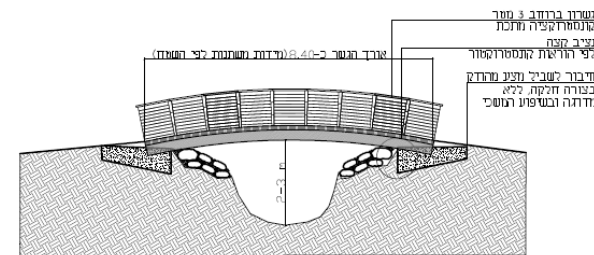

הגדלה מקטע מעקה לדוגמא 1:20

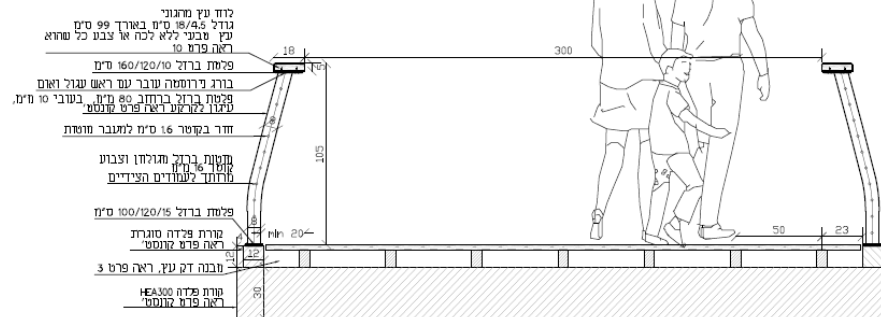

חתך טיפוסי קני"מ 1:20

Railing Detail

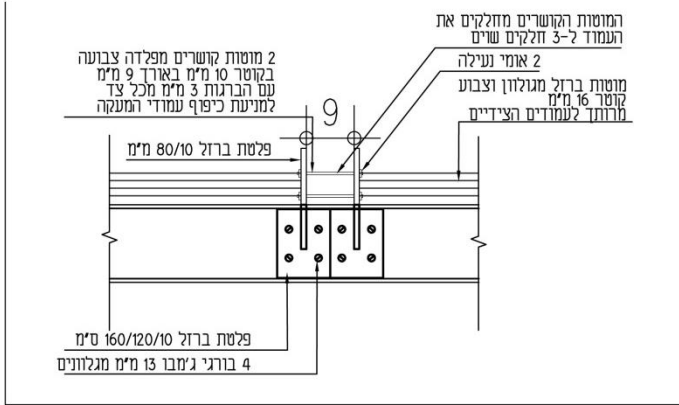

פרט עמודי המתיחה של מוטות 1:10
עמוד כפול - כל 6 מ' ובמקומות בהם ישנו שינוי בגובה המעקה

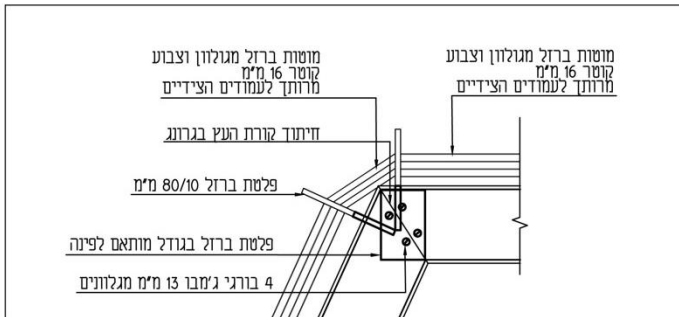

פרט פינה 1:10

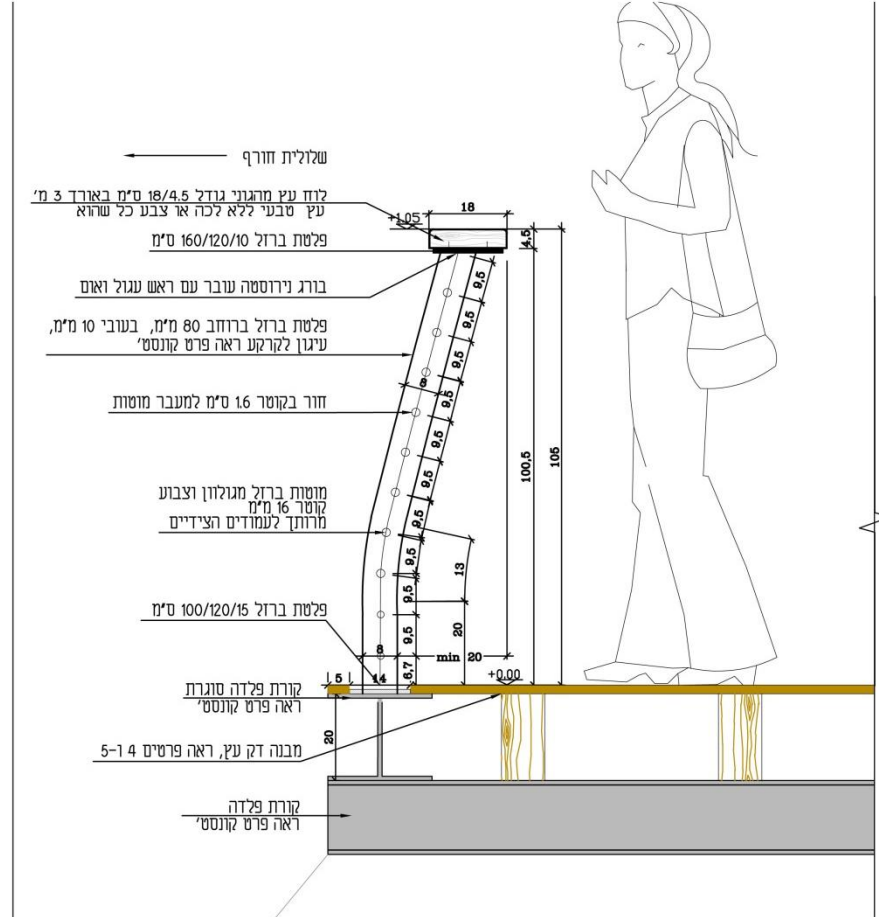

מעקה "אופקי" - חתך אופייני 1:10

הערות:

כל החומרים, האיבריים והחיבורים יהיו בהתאם למפרט הסכני. כל פרטי הפלדה יהיו מגלונים, 100 מיקרון, וצבועים 250 מיקרון, לפי המפרט הסכני.

	שם הקובץ: 17.04.14 P:\486 286 יוניברסל OFFICE\DETAILS\486-03B.DWG	תאריך: 17.04.14	מהדורה:	שם הפרוייקט: פארק אריאל שרון - מתחם המגוון הביולוגי	ברידא • מעוז אדריכלות נוף בע"מ BRAUDO • MAOZ LANDSCAPE ARCHITECTURE LTD
	אין לבקש מידות ע"י מדידה בשרטוט. המכשע אחראי לבדיקת המידות והתאמתן במקום ועכ"ל להודיע כמתכנתת על ככל טעות או אי התאמה.	תאריך עידכון:	תוכן הגיליון: מעקה - פרט אופייני	ר"ד יוסף בארז 18, ת"א 6701422 נוב, 03-7528197. בק. 03-7515827	

View from the bridge into the canal



Fountain pool





7

**TERRACE PATH
MATERIALS:**

**BRUSHED RECYCLED
CONCRETE**

WOODCHIPS

Biodiversity area: Pedestrian + bicycle path

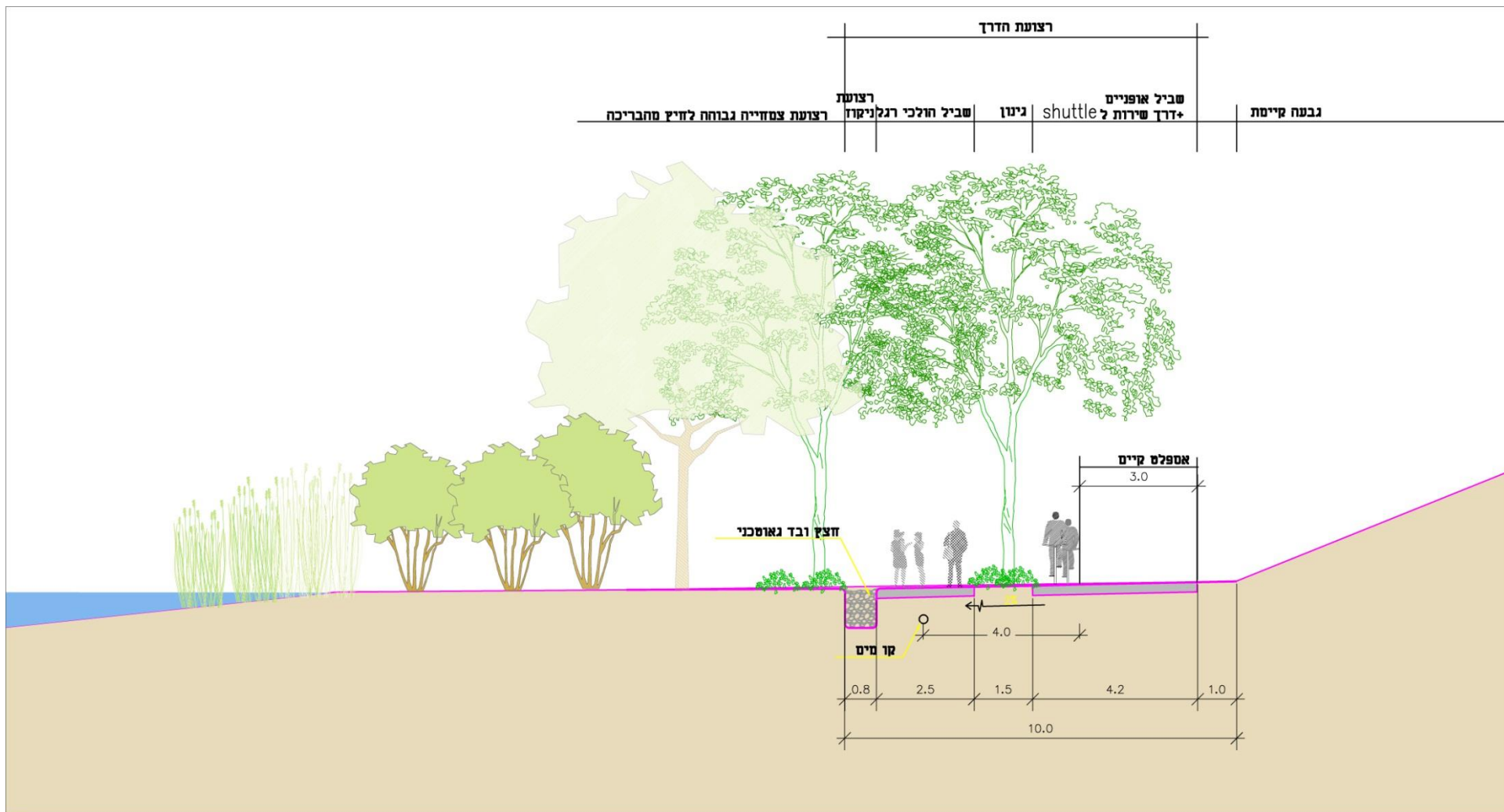

Biodiversity area: Pedestrian + bicycle path

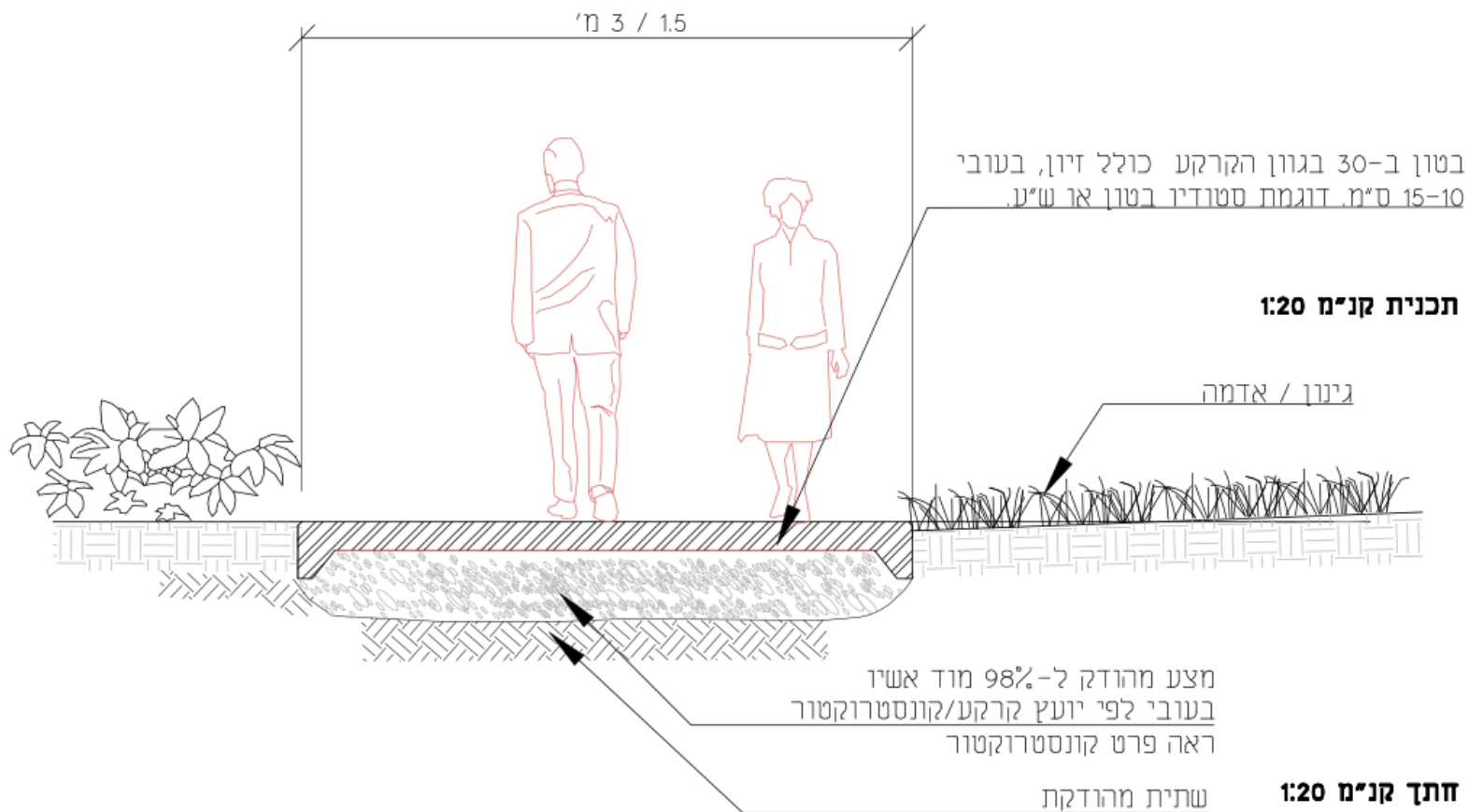

	שם הקובץ: 17.04.14 תאריך:	מהדורה:	שם הפרוייקט: פארק אריאל שרון - מתחם המגוון הביולוגי	בראדו • מאוז אדריכלות נוף בע"מ BRAUDO • MAOZ LANDSCAPE ARCHITECTURE LTD רדוד יוסף בן-דוד 18, רמת 6701422 נב. 03-7528197 מק. 03-7515827
	P:486 OFFICE/DETAILS/D486-03B.DWG שם הקובץ:	תאריך עידכון: 18.01.15	תוכן הגיליון: שביל מצע מהודק	



Planting concept



Boardwalk trees



מיש דרומי
Celtis australis

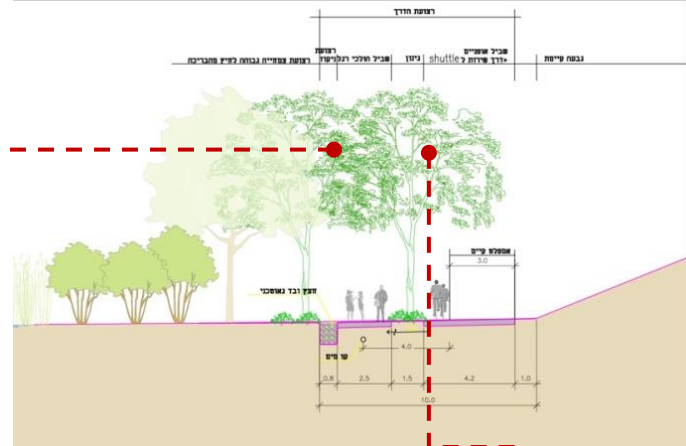

עץ מוביל – מיש בונגה ("גשר הזיו")
Celtis bungeana



Arundo as a natural buffer



Idea images of biodiversity pools



בריכות מגוון ביולוגי כדוגמה

משרד ברודא מעוז - אדריכלות נוף בע"מ

Underwater planting area

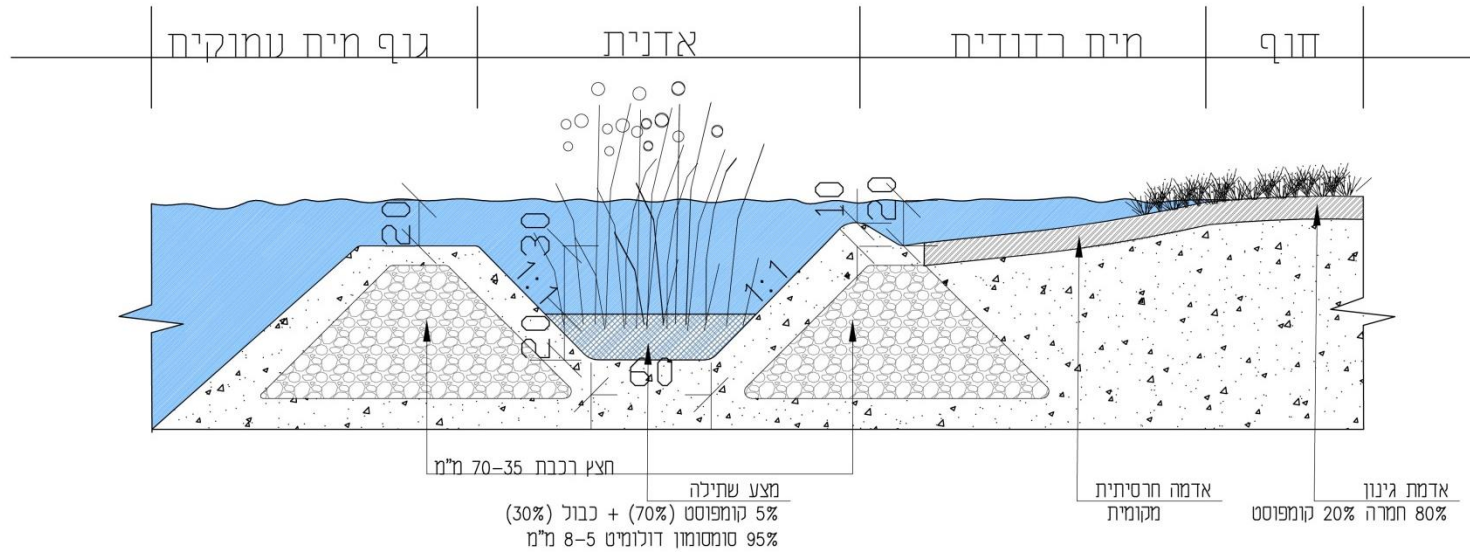

חזק 1:20

	שם הקובץ: 15.01.15 תאריך: 15.01.15 P:\486\OFFICE\DETAILS\ID486-03B.DWG (תוכנו יגולויב שאם 486)	מהדורה:	פארג אריאל שרון- מתחם המגוון הביולוגי	שם הפרוייקט:	ברידא • מאז אדריכלות נוף בע"מ BRAUDO • MAOZ LANDSCAPE ARCHITECTURE LTD
	אין לבקוע מידות עיי מדידה. בשרטוט. המבצע אחראי לבדיקת המידות והתאמתן במקום ועליו להודיע למתכנת על כלי טעות או אי התאמה.	תאריך עידכון:	תוכן הגיליון:	אדנית בשולי הבריכה	רח' יוסף קארד 18, ת"א 6701422 נב. 03-7528197. בקס. 03-7515827

The biodiversity area

